

MONUMENT RECORD

Corner I.D. #

I-23

STATE OF INDIANA - COUNTY OF MONROE

Section Thirty-three, Township 8 North, Range 1 East

Monument Description & Remarks: Found Sandstone Stone w/"X" at West 1/4
Corner. Stone was loose in ground & appeared to be broken off; could not
find base. Stone was made firm in ground & survey marker sign & post set.

Recovery Tie Drawing

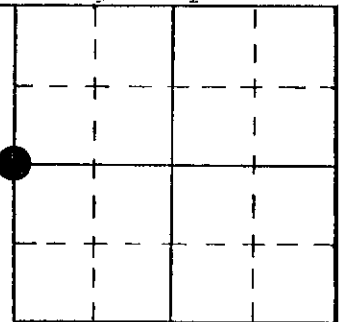
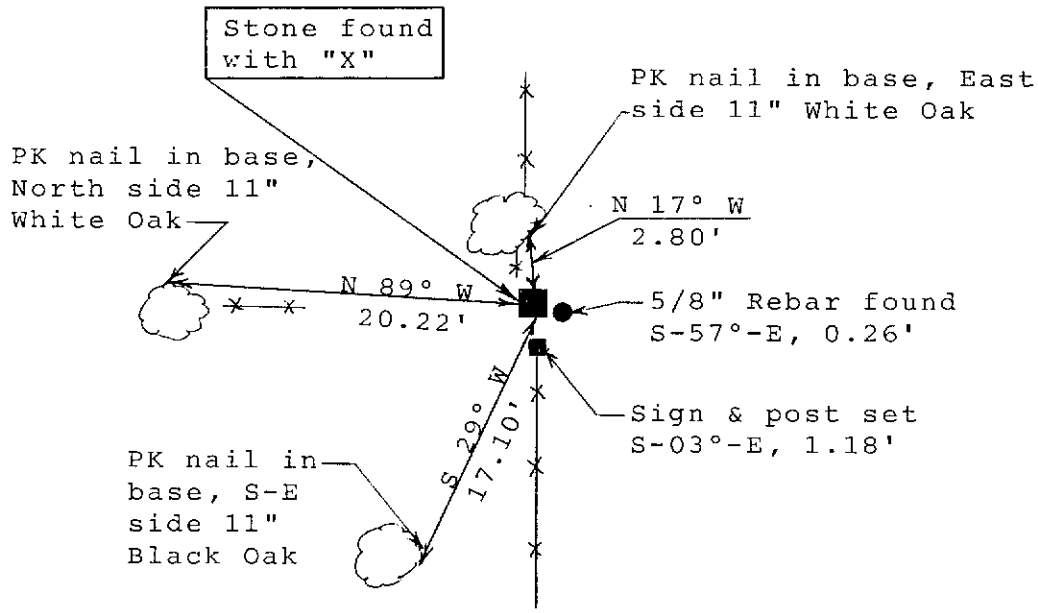

● At Corner



Not To Scale

Note: Rebar found supports stone as true corner
Fences shown *-*-* are old, down barbed wire.

State of Indiana
County of MONROE

Space
Reserved For
Recording
Officer

I, M.W.F. MICHAEL W. FRILEY, COUNTY SURVEYOR, hereby certify that this document was prepared under my direction in accordance with the provisions of Section 17-3-64-4 through 17-3-64-8 of the Indiana Code, being Acts of 1965, Chapter 319; and the above data is given under my hand and seal this 19th day of April, 1995 A.D.

Indiana Registered Land Surveyor No. _____ or

Field Book:

OFFICE OF MONROE COUNTY SURVEYOR

95-01

United States Government Agency

Page:

MONROE COUNTY SURVEYOR

28

Title